



Wire Accessories

Spiral Wrap	F2
Split Loom	F3
Nylon Cable Clamps	F4
Clips	
Adhesive Base Clips	F5-F7
Adhesive Wire Saddles	F7
Standard Hose Clamps	F8
Twist Clips, Spring Clips	F9
Nail Cable Clips	F9-F10
Push in Releasable Cable Clips, Push-in Wire Saddle	F11
Push in Twist Clips with Standoff, Lock-in Wire Saddles, Twist Clips	F12-F14
Rubber Grommets	F15

ETLIN DANIELS reserves the right to discontinue, modify designs and change specifications without incurring obligation. While every effort is made to ensure that descriptions, specifications and other information in this catalogue are correct, no warranty is given in respect thereof and the company shall not be liable for any error herein.
Copyright © 2013 **ETLIN DANIELS**

SPIRAL WRAP PROTECTIVE SHEATHING

F2

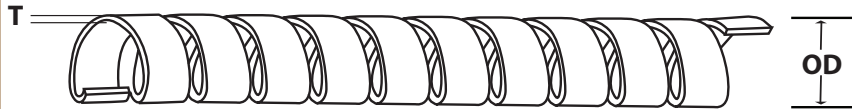

Non-Flame Retardant Polyethylene

ITEM NUMBER	OD DIAMETER (OD)		WALL THICKNESS (T)		BUNDLE RANGE (inches)
	inch	mm	inch	mm	
1NFP	.125	3.18	.032	.81	1/16 - 1/4
1.5NFP	.250	6.35	.035	.89	3/16 - 2
2NFP	.250	6.35	.045	1.14	3/16 - 2
2.2NFP	.375	9.53	.040	1.02	3/16 - 2
2.5NFP	.375	9.53	.052	1.32	5/16 - 3
2.6NFP	.375	9.53	.062	1.57	5/16 - 3
2.7NFP	.500	12.70	.030	0.76	3/8 - 3
2.8NFP	.500	12.70	.040	1.02	3/8 - 4
3NFP	.500	12.70	.062	1.57	3/8 - 4
3.1NFP	.500	12.70	.072	1.83	3/8 - 4
3.5NFP	.625	15.87	.062	1.57	5/8 - 4 1/2
4NFP	.750	19.05	.065	1.65	3/4 - 5
4.5NFP	1.000	25.40	.070	1.77	1 - 7
5NFP	1.000	25.40	.095	2.41	1 - 7

Non- Flame Retardant Spiral Wrap Protective Sheathing

Non-flame retardant polyethylene for general-purpose indoor use. Temperature Range: -80°F(-62°C) to 212°F(100°C). For weather resistant Polyethylene, add suffix -UV to part number. (Polyethylene is not affected by ordinary solvents and is resistant to abrasion.

Flame Retardant Polyethylene

ITEM NUMBER	OD DIAMETER (OD)		WALL THICKNESS (T)		PITCH		BUNDLE RANGE (inches)
	inch	mm	inch	mm	inch	mm	
1FRP	.125	3.18	.032	.81	.187	4.75	1/16 - 1/4
2FRP	.250	6.35	.045	1.14	.375	9.53	3/16 - 2
2.5FRP	.375	9.53	.052	1.32	.438	11.13	5/16 - 3
3FRP	.500	12.70	.062	1.57	.563	14.30	3/8 - 4
4FRP	.750	19.05	.065	1.65	.750	19.05	3/4 - 5
5FRP	1.000	25.40	.095	2.41	.999	25.40	1 - 7

Flame Retardant Spiral Wrap Protective Sheathing

Flame retardant polyethylene, self-extinguishing.

Forms a flexible sheath to bundle, harness, protect or insulate wires, cables, tubing or hoses. The inner edges are rounded to protect the lead out cables. Spiral wrap is re-useable and is resistant to most chemicals, including aircraft fuels and hydraulic oils.

Spiral wrap is available in a broad range of colours, for a colour other than natural, please contact our office.

SPLIT LOOM

F3

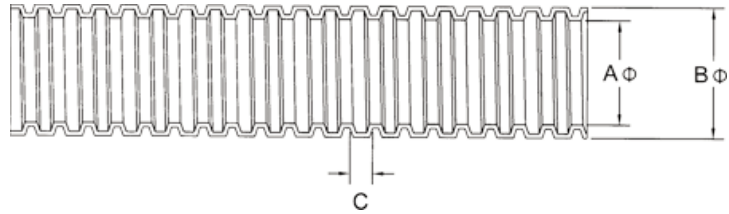

Standard Polypropylene Black

ITEM NUMBER	A		B		C		SIZE (inches)
	inches	mm	inches	mm	inches	mm	
22SL0250PP	.266"	6.8	.395"	10.0	.120"	3.05	1/4"
22SL0375PP	.419"	10.6	.535"	13.6	.128"	3.25	3/8"
22SL0500PP	.505"	12.8	.670"	17.0	.143"	3.63	1/2"
22SL0625PP	.650"	16.5	.825"	21.0	.145"	3.68	5/8"
22SL0750PP	.761"	19.3	.927"	23.6	.144"	3.66	3/4"
22SL1000PP	.909"	23.1	1.033"	26.2	.172"	4.37	1"

Convuluted Split Loom provides protection from heat, sunlight, water, snow, ice, friction wear, fraying and puncture.

Split loom has a slit for easy insertion of wires over a long run. Soft and very flexible.

Made from Polyethylene in Black 100 foot rolls.

Temperature Range - 40°C to 90°C (-40°F to 200°F)

Non- Flame Retardent Spiral Wrap Protective Sheathing

All split loom is manufactured in BLACK

ALL NYLON Split Loom has a GRAY stripe for identification.

ALL FR POLYPROPYLENE Split Loom has a BLUE stripe.

Flame Retardant* Polypropylene Black

ITEM NUMBER	A		B		C		SIZE (inches)
	inches	mm	inches	mm	inches	mm	
22SL0250FRPPBL	.266"	6.8	.395"	10.0	.120"	3.05	1/4"
22SL0250FRPPBL	.419"	10.6	.535"	13.6	.128"	3.25	3/8"
22SL0500FRPPBL	.505"	12.8	.670"	17.0	.143"	3.63	1/2"
22SL0625FRPPBL	.650"	16.5	.825"	21.0	.145"	3.68	5/8"
22SL0750FRPPBL	.761"	19.3	.927"	23.6	.144"	3.66	3/4"
22SL1000FRPPBL	.909"	23.1	1.033"	26.2	.172"	4.37	1"

Flame Retardant* Polypropylene Black

*FR Polypropylene split loom has a blue strip identifier

Wire
Accessories

NYLON CABLE CLAMPS

F4

Nylon Cable Clamps

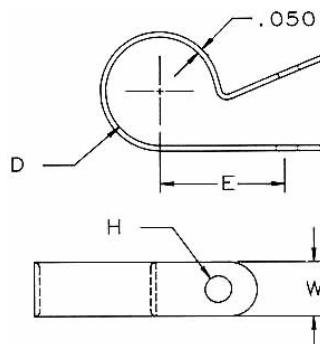

ITEM NUMBER	DIMENSIONS IN INCHES				DIMENSIONS IN MM			
	D	E	H	W	D	E	H	W
3302	1/8"	.329	.203	3/8"	3.2	8.36	5.16	9.5
3303	3/16"	.430	.203	3/8"	4.8	10.92	5.16	9.5
3304	1/4"	.410	.203	3/8"	6.3	10.41	5.16	9.5
3305	5/16"	.495	.203	3/8"	7.9	12.57	5.16	9.5
3306	3/8"	.595	.203	3/8"	9.5	15.11	5.16	9.5
3307	7/16"	.574	.203	3/8"	11.1	14.58	5.16	9.5
3308	1/2"	.605	.203	3/8"	12.7	15.37	5.16	9.5
3309	9/16"	.678	.203	3/8"	14.3	17.22	5.16	9.5
3322	1/8"	.315	.203	1/2"	3.2	8.00	5.16	12.7
3323	3/16"	.425	.203	1/2"	4.8	10.80	5.16	12.7
3324	1/4"	.410	.203	1/2"	6.3	10.41	5.16	12.7
3325	5/16"	.500	.203	1/2"	7.9	12.70	5.16	12.7
3326	3/8"	.530	.203	1/2"	9.5	13.46	5.16	12.7
3327	7/16"	.560	.203	1/2"	11.1	14.22	5.16	12.7
3328	1/2"	.595	.203	1/2"	12.7	15.11	5.16	12.7
3329	9/16"	.606	.203	1/2"	14.3	15.39	5.16	12.7
3330	5/8"	.655	.203	1/2"	15.9	16.64	5.16	12.7
3331	11/16"	.755	.203	1/2"	17.4	19.18	5.16	12.7
3332	3/4"	.780	.203	1/2"	19.0	19.81	5.16	12.7
3333	13/16"	.815	.203	1/2"	20.6	20.70	5.16	12.7
3334	7/8"	.845	.203	1/2"	22.2	21.46	5.16	12.7
3340	1"	.910	.203	1/2"	25.4	23.11	5.16	12.7
3342	1-1/8"	.970	.203	1/2"	28.6	24.63	5.16	12.7
3343	1-3/16"	1.00	.203	1/2"	30.1	25.40	5.16	12.7
3344	1-1/4"	1.06	.203	1/2"	31.8	26.92	5.16	12.7
3346	1-3/8"	1.125	.203	1/2"	34.9	28.57	5.16	12.7
3348	1-1/2"	1.19	.203	1/2"	38.1	30.23	5.16	12.7

Nylon Cable Clamps

For clamping cables or tubing securely in place. Made from tough, resilient, chemical resistant nylon.

Molded in open position for easy assembly. Radius edges protect against insulation abrasion.

They are also available in black by adding the suffix - "BL"

ADHESIVE BASE CABLE CLIPS

Cable Clips

F5

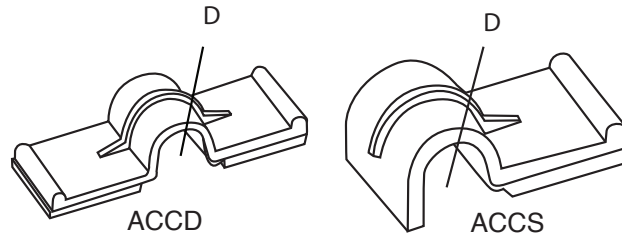
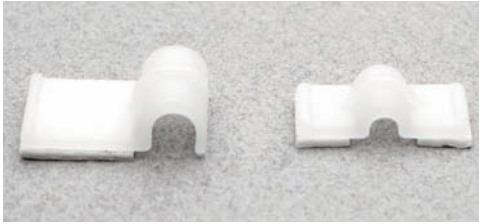

ITEM NUMBER	FOR CABLE DIAMETER (D)
ACCD-1/8	UP TO 1/8"
ACCD-1/4	UP TO 1/4"
ACCD-3/8	UP TO 3/8"
ACCD-1/2	UP TO 1/2"
ACCS-1/8	UP TO 1/8"
ACCS-1/4	UP TO 1/4"
ACCS-3/8	UP TO 3/8"
ACCS-1/2	UP TO 1/2"

Double Backed Cable Clips

A convenient and fast way to install wires and cable to almost any surface. Nylon cable clips provide a low in-place assembly that is quick and permanent. The double clip design develops greater shear loads and holding power. Tough, corrosion resistant Nylon 6/6 clip is backed with a quality foam adhesive tape. Polyurethane foam tape has excellent conformability, high temperature and solvent resistance and high ultimate bond strength.

Single Backed Cable Clips

Tough, corrosion resistant Nylon 6/6 clip is backed with a quality foam adhesive tape. Polyurethane foam tape has excellent conformability, high temperature and solvent resistance and high ultimate bond strength.

The single clip is designed to be used in areas where space is limited or in corners or edges. To install, simply pull the clip off the backing and press into place, no holes to drill or screws to turn.

Releasable, Adjustable Cable Clips

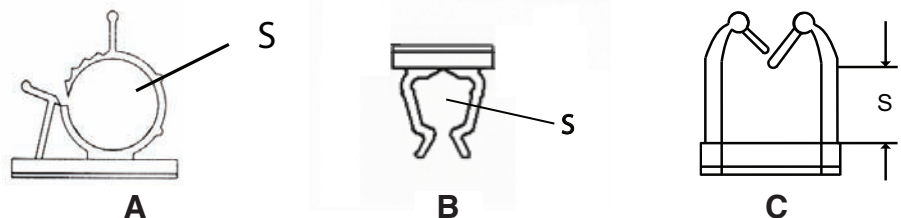
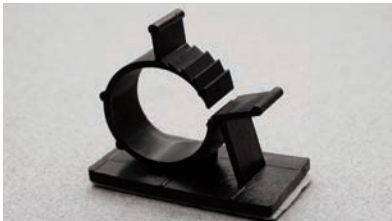

ITEM NUMBER	FOR CABLE DIAMETER (S)	FIGURE
AP-0810	.315" TO .395"	A
AP-1013	.395" TO .500"	A
AP-1316	.500" TO .630"	A
AP-1720	.670" TO .785"	A
AP-2225	.850" TO 1.00"	A
AWCS312	0.200"	B
MWCA500	0.250"	C

Releasable, Adjustable Cable Clips

One size of adjustable clamp can accommodate various cables that will save your cost stock.

Easy to install; open for unlimited usage.

Made of UL Approved Black Nylon 66 94V2 (backed with adhesive tape).

ADHESIVE BASE CABLE CLIPS

F6

Miniature Wire Saddle

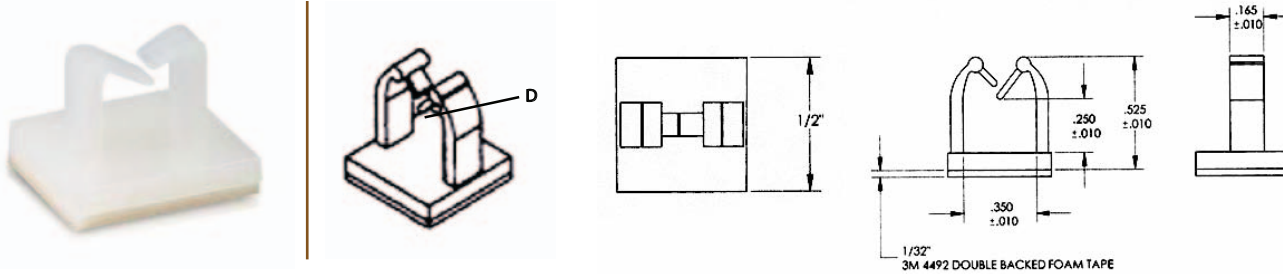

ITEM NUMBER	FOR CABLE DIAMETER D
TSCA-0500	.236" TO .275"

Miniature Wire Saddle

Adhesive Backed Clip eliminates the need for mounting holes. Molded in Nylon 6/6 natural, this item is good for space saving applications due to the small base.

Releasable Cable Clips

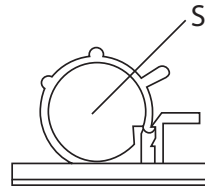
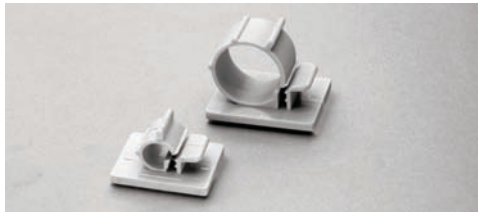

ITEM NUMBER	FOR CABLE DIAMETER (S)
TS-0607	.236" TO .275"
TS-0708	.275" TO .315"
TS-0910	.350" TO .395"
TS-1214	.475" TO .550"
TS-1618	.630" TO .705"

Releasable Cable Clips

Two stage lock design to accommodate different cable sizes in one clamp. Made of UL Approved Grey Nylon 66, 94V2 (backed with adhesive tape).

Flat Cable Clips

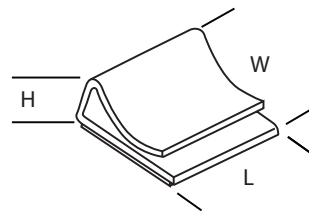

ITEM NUMBER	SIZE L x W	HEIGHT (H)
FC-15	.590" L X 1.00" W	0.354
FC-20	.785" L X 1.00" W	0.354
FC-25	1.00" L X 1.00" W	0.354
FC-28	1.10" L X 1.00" W	0.354
SFC-15	.590" L X .511" W	0.254"
SFC-20	.787" L X .511" W	0.254"
SFC-25	.984" L X .511" W	0.254"
SFC-28	1.10" L X .511" W	0.254"

Flat Cable Clips

Made of Grey PVC backed with quality adhesive tape. Conducts flat cable neatly and firmly, simply insert the cable into the clamp and the job is done.

ADHESIVE BASE CABLE CLIPS

Adhesive Wire Clips

F7

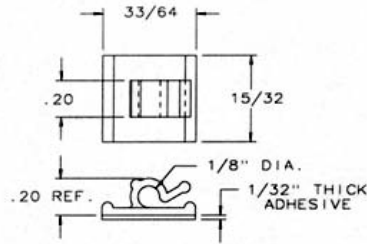

AWC125

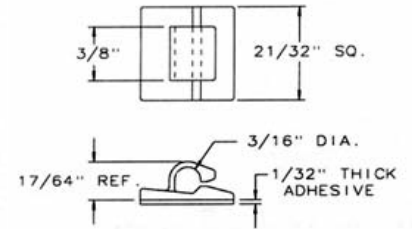

AWC187

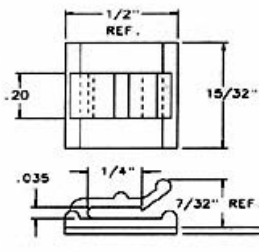

AWCF250047

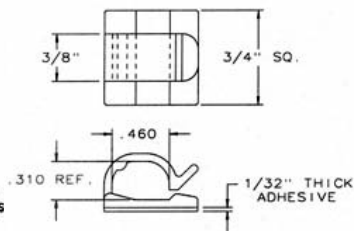

AWC375

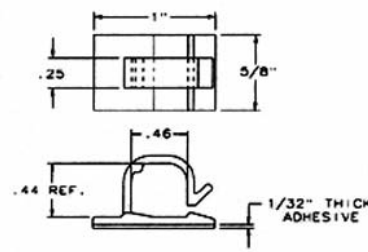

AWC440

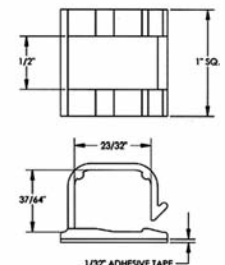

AWC580

ITEM NUMBER	SIZE
AWC125	.125" DIA
AWC187	.187" DIA
AWCF250047	.245" W X .035" H
AWC375	.460" W X .310" H
AWC440	.460" W X .440" H
AWC580	.718" W X .578" H

Adhesive Wire Clips

For routing wires and cables. The parts are backed with Polyurethane foam tape. Clip is releasable so that wires can be removed after assembly.

Adhesive Wire Saddles

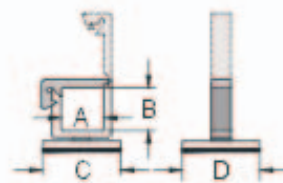

AWS-11

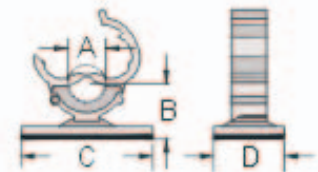

AWS-9R

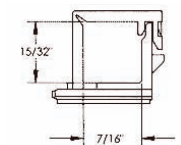

AWCS-438469

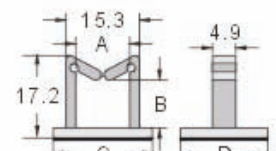

AWS-1210

ITEM NUMBER	A inches (mm)	B inches (mm)	C inches (mm)	D inches (mm)
AWS-11	0.44(11.2)	0.43(11.0)	0.78(20.0)	0.78(19.8)
AWS-9R	0.33(8.5)	0.53(13.6)	1.17(29.8)	0.63(16.0)
AWCS-438469	0.44(11.3)	0.39(10.0)	0.81(20.7)	0.72(18.3)
AWS-1210	0.44(11.2)	0.45(11.6)	0.62(15.8)	0.37(9.5)

Adhesive Base Wire Saddles

Made of UL Approved Nylon 66 94V2 (backed with adhesive tape).

STANDARD NYLON HOSE CLAMPS

F8

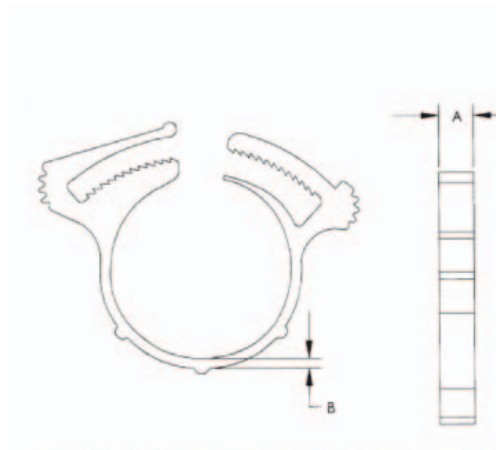

Standard Nylon Hose Clamps

Hose Clamps

Nylon 6/6 (natural), with releasable overlapping tapered ring fastened around the hose/cable. It is secured to the required tightness by compressing the interacting grooves in a ratcheting manner.

ITEM NUMBER	A (mm)	B (mm)	CLAMPING RANGE inches(mm)
HSC010	0.156 (+/- 0.005)	0.040 (+/- .015)	0.009-0.010(0.235-0.26)
HSC015	0.150 (+/- 0.005)	0.050 (+/- .015)	0.011-0.012(0.283-0.312)
HSC020	0.230 (+/- 0.005)	0.070 (+/- .015)	0.014-0.015(0.35-0.395)
HSC040	0.230 (+/- 0.005)	0.070 (+/- .015)	0.014-0.016(0.36-0.41)
HSC060	0.230 (+/- 0.005)	0.070 (+/- .015)	0.017-0.019(0.43-0.48)
HSC080	0.230 (+/- 0.005)	0.070 (+/- .015)	0.019-0.021(0.5-0.545)
HSC100	0.230 (+/- 0.005)	0.070 (+/- .015)	0.020-0.024(0.525-0.605)
HSC120	0.230 (+/- 0.005)	0.070 (+/- .015)	0.023-0.026(0.58-0.66)
HSC140	0.230 (+/- 0.005)	0.070 (+/- .015)	0.026-0.295(0.65-0.75)
HSC180	0.230 (+/- 0.005)	0.070 (+/- .015)	0.031-0.035(0.779-0.899)
HSC190	0.230 (+/- 0.005)	0.070 (+/- .015)	0.034-0.039(0.859-0.989)
HSC220	0.250 (+/- 0.005)	0.070 (+/- .015)	0.035-0.042(0.9-1.072)
HSC240	0.250 (+/- 0.005)	0.070 (+/- .015)	0.039-0.045(0.99-1.135)
HSC280	0.280 (+/- 0.005)	0.070 (+/- .015)	0.044-0.051(1.123-1.296)

ADHESIVE BASE CABLE CLIPS SCREW MOUNT CLIPS & NAIL CABLE CLIPS

F9

Twist Clips

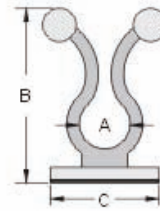

ITEM NUMBER	A (mm)	B (mm)	C (mm)
ATTB-08(ATC375)	0.31"	1.08"	0.69"
ATTB-15	0.58"	1.39"	0.87"
ATTB-20	0.81"	1.57"	1.003"

Adhesive Base Twist Clips

Peel off adhesive paper prior to use, insert cables into twist lock, and twist ends to close.

Made of UL Approved Nylon 66 94V2 (backed with adhesive tape).

Spring Wire Clips

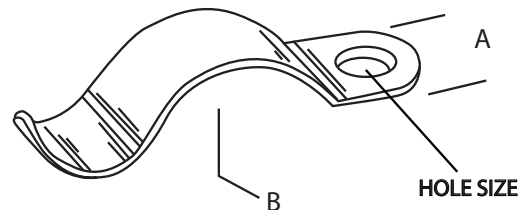

ITEM NUMBER	A	B	HOLE SIZE
WC500312	0.500"	up to 0.312"	0.182"
SCP375132	0.375"	up to 0.265"	0.179"

Spring Wire Clips

Provides a fast, secure assembly and routing of wires, standard round cable, flat cable and tubing. Can also be used to mount panels, glass, displays or signs.

To inspect, add or replace wires, simply pull back the clip to allow placement. The tough, flexible Nylon clip will spring back to hold the material securely. All contact edges are rounded for product protection.

Nail Cable Clips

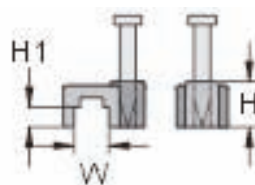

NF-0.18

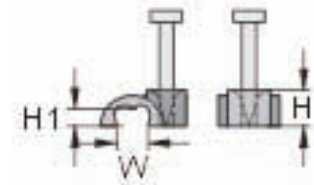

NFR-1 NFR-1S

Nail Cable Clips

Nail cable clips are designed to secure cables with an inserted nail. Just hammer the nail to your mounting surface. Perfect for retrofitting cables. Impact resistant white polyethylene For telephone cords, flat cable. Inserted steel nail for masonry.

ITEM NUMBER	W	H	H1	SUITABLE WIRE	NAILS
NF-0.18	0.18"(4.5)	0.17"(4.3)	0.11"(2.7)	0.0314in ² 2C	0.08" x 0.59"
NFR-1	0.20"(5.1)	0.27"(6.8)	0.12"(3.0)	0.0314in ² 2C	0.10" x 0.71"
NFR-1S	0.20"(5.1)	0.27"(6.8)	0.12"(3.0)	0.0314in ² 2C	0.08" x 0.78"

Wire Accessories

NAIL CABLE CLIPS

F10

Nail Cable Clips

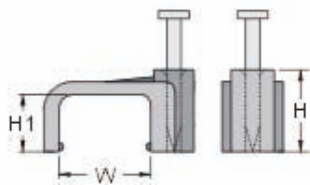

Standard Design

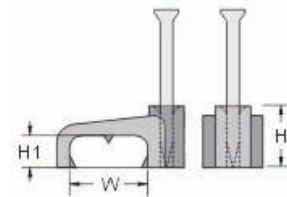

NF2.6S

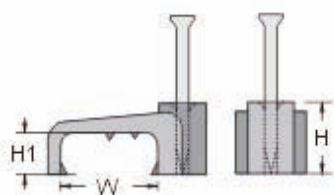

NF2.8S

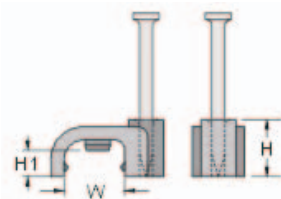

NFD-0508GY, 0610GY

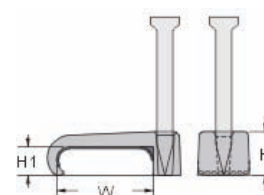

NFP-2.1

ITEM NUMBER	W (mm)	H (mm)	H1 (mm)	SUITABLE WIRE	NAILS (mm)
NF-0.25	2.1	4.5	1.2		1.65 x 15
NF-0.7	5.5	5.5	3.1		2.0 x 15
NF-1.2	6.2	6.4	3.8		2.0 x 15
NF-1.4	6.4	7	4.1		2.0 x 25
NF-1.6	8	8	5	1mm ² T & E	2.0 x 15
NF-2.0S	8.5	8	5.2	1.5mm ² T & E	2.0 x 25
NF-2.2S	10	10	6.5	2.5mm ² T & E	2.0 x 25
NF-2.3	10.2	8	4.6		2.0 x 25
NF-2.6S	11.9	9.6	6.2	6mm ² T & E	2.0 x 25
NF-2.8S	15	11	6.8	4mm ² T & E	2.0 x 25
NFT-1.5	9.8	6.7	4.4	1.5mm ² T & E	2.0 x 25
NFT-4.0	11.6	9.7	6.4	4mm ² T & E	2.0 x 25
NFD-1.0	16.8	7.2	4.4	1.0 / 1.5mm ² Double T & E	2.0 x 25
NFP-2.1	9.3	8.7	4	1 & 1.5mm ² T & E	2.0 x 25
NF-2.0	8.5	8	5.2	1.5mm ² T & E	2.5 x 18
NF-2.2	10	10	6.5	2.5mm ² T & E	2.5 x 18
NF-2.6	13.5	11.6	8.1	6mm ² T & E	2.5 x 22
NF-2.8	15	12.8	8.7		2.5 x 22
NF-3.0	18	12.9	9.5	10mm ² T & E	2.5 x 27
NF-3.2	19	14.2	11.1		2.5 x 27
NFT-16	20.2	13.2	10.1	16mm ² T & E	2.5 x 35
NF-1122	20.8	14.5	11		2.0 x 35
NFD-0508GY	15.1	7	4.5	2 x 1.0 and 1.5mm T & E Cable	2.5 x 25
NFD-0610GY	19.2	8.4	5.3	2 x 2.5mm T & E Cable	2.5 x 25
NFD-2.5	19.3	8.7	5.5	2.5mm ² Double T & E	2.5 x 30
NF-5.0	49	33	26		4.0 x 50

Wire Accessories

PUSH-IN MOUNT CABLE CLIPS

Releasable, Push-In Cable Clips

F11

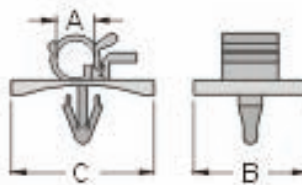

ITEM NUMBER	A inches(mm)	B inches(mm)	C inches(mm)	Hole Size inches(mm)
PTS-0607	0.24-0.28(6~7)	0.79(20.0)	0.98(25.0)	0.19"(4.8)
PTS-0708	0.28-0.31(7~8)	0.79(20.0)	0.98(25.0)	0.19"(4.8)
PTS-0910	0.35~0.39(9~10)	0.96(24.5)	1.18(30.0)	0.19"(4.8)
PTS-1214	0.47~0.55(12~14)	0.96(24.5)	1.18(30.0)	0.19"(4.8)
	0.63~0.71(16~18)	0.96(24.5)	1.18(30.0)	0.19"(4.8)

Releasable, Push-In Cable Clips

Two stage lock design to accommodate different cable sizes in one clamp.

Mounts into a 4.8 mm diameter hole.

Made of UL Approved Grey Nylon 66, 94V2.

Push-in Wire Saddle



Wire Saddle Clips

- Material: UL approved Nylon 66, 94V-2
- Color: Natural

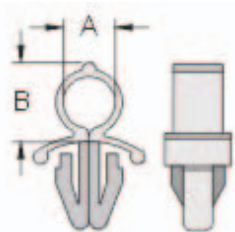

RH-5. 8

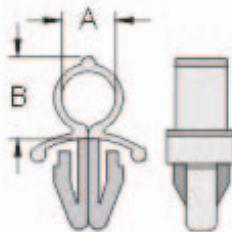

RH-6

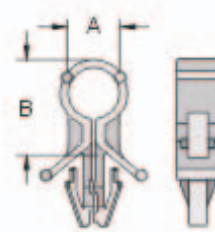

RH-9

ITEM NUMBER	A inches(mm)	B inches(mm)	HOLE inches(mm)	Thickness inches(mm)
RH-5	0.31(8)	0.20(5.1)	0.22(5.5)	0.08(2)
RH-6	0.37(9.5)	0.24(6.2)	0.31(8)	0.07(1.8)
RH-8	0.45(11.5)	0.30(7.5)	0.24(6.2)	0.08(2)
RH-9	0.71(18)	0.38(9.6)	0.37(9.5)	0.08(2)

PUSH-IN MOUNT CABLE CLIPS WIRE SADDLES & TWIST CLIPS

F12

Push-In Twist Clips With Standoff



Push-In Twist Clips with Standoff

Locks into a pre-drilled 4.8 mm hole. Cables assemble into "W" part and clamp locks with a twist.

Made of UL Approved Nylon 66 94V2.

ITEM NUMBER	H1	H2	W	Mounting Hole	Thickness
ST-1	.83"	1.22"	.24"	(0.18"-0.19")	(0.04"-0.11")
ST-2	1.18"	.71"	.43"	(0.19"-0.20")	(0.04"-0.11")
ST-3	1.18"	.16"	.43"	(0.18"-0.19")	(0.04"-0.11")
ST-3B	1.20"	.12"	.43"	(0.24"-0.26")	(0.02"-0.08")
ST-3C	1.20"	.09"	.58"	(0.18"-0.19")	(0.02"-0.06")
ST-3D	1.36"	.08"	.72"	(0.17"-0.19")	(0.04"-0.09")
ST-4S	1.18"	.50"	.43"	(0.165"-0.19")	(0.04"-0.09")
ST-4	1.32"	.34"	.60"	(0.18"-0.19")	(0.04"-0.08")
ST-0560	.85"	2.29"	.20"	(0.18"-0.20")	(0.06"-0.12")
ST-1112	1.00"	.48"	.43"	(0.18"-0.19")	(0.06"-0.12")
ST-1247	1.05"	1.83"	.47"	(0.18"-0.19")	(0.06"-0.12")
ST-1602	1.26"	.10"	.63"	(0.17"-0.18")	(0.04"-0.11")
ST-2403	1.70"	.125"	.94"	(0.19"-0.20")	(0.02"-0.10")

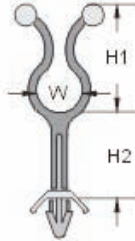

Standard Design

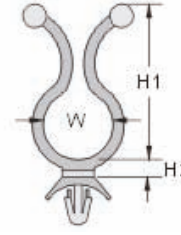

ST-3C

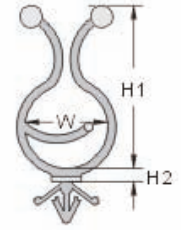

ST-3D

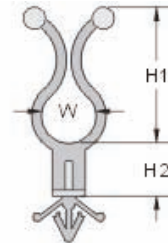

ST-4S

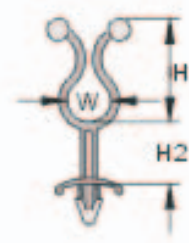

ST-1112 & ST-1247

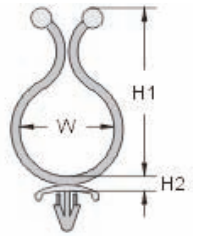

ST-2403

Wire Accessories

Push-in Lock-in Wire Saddles

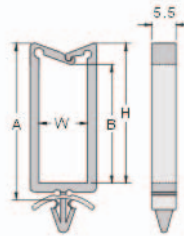

KWS-0,1,2,3

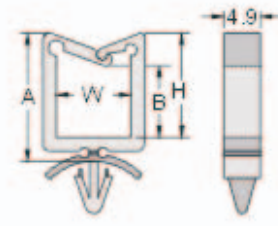

KWS-2L

ITEM NUMBER	H	A	B	W	Hole	Thickness
KWS-0	0.35"	0.51"	0.16"	0.43"	0.19"	0.079"
KWS-1	0.56"	0.75"	0.41"	0.43"	0.19"	0.079"
KWS-2	0.91"	1.06"	0.75"	0.43"	0.19"	0.079"
KWS-2L	0.59"	0.71"	0.47"	0.41"	0.19"	0.079"
KWS-3	1.22"	1.41"	1.10"	0.43"	0.19"	0.079"

Lock-in Wire Saddles

- Material: UL approved Nylon 66, 94V-2
- Color: Natural
- For directing and gathering cables at low cost. Locking into 4.8mm diameter mounting hole with fingertip pressure. Self adjust to various panel thickness.

PUSH-IN MOUNT CABLE CLIPS WIRE SADDLES

Push-in Lock-in Wire Saddles

F13

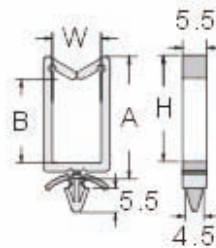
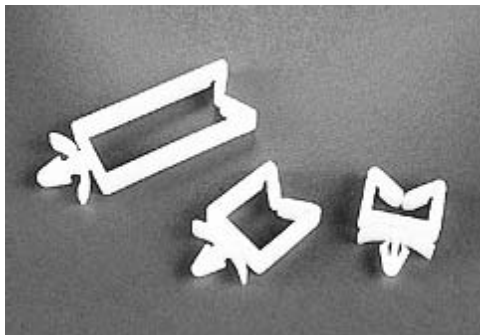

KWS-0N, 1N, 2N, 3N

Lock-in Wire Saddles

- Material: UL approved Nylon 66, 94V-2
- Color: Natural
- For directing and gathering cables at low cost. Locking into 4.8mm diameter mouting hole with fingertip pressure. Self adjust to various panel thickness.

ITEM NUMBER	H inches(mm)	A inches(mm)	B inches(mm)	W inches(mm)	Hole inches(mm)	Thickness inches(mm)
KWS-0N	0.36"(9.2)	0.50"(12.7)	0.16"(4)	0.43"(11)	0.19"(4.8)	0.079"(2)
KWS-1N	0.45"(11.4)	0.70"(17.9)	0.34"(8.6)	0.43"(11)	0.19"(4.8)"	0.079"(2)
KWS-2N	0.92"(23.4)	1.06"(26.9)	0.72"(18.2)	0.43"(11)	0.19"(4.8)	0.079"(2)
KWS-3N	1.23"(31.3)	1.37"(34.8)	1.03"(26.2)	0.43"(11)"	0.19"(4.8)	0.079"(2)"

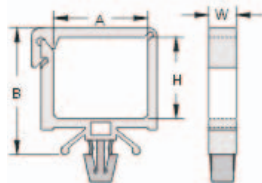
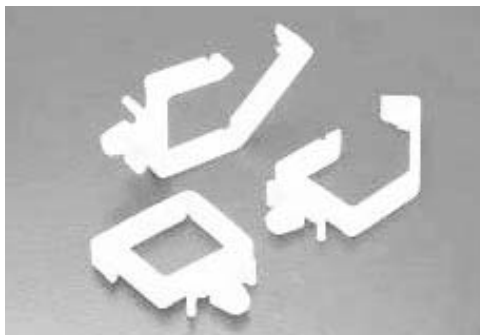

PWS-1715

Wire Saddles

- Material: UL approved Nylon 66, 94V-2
- Color: Natural

ITEM NUMBER	H inches(mm)	A inches(mm)	B inches(mm)	W inches(mm)	Hole inches(mm)	Thickness inches(mm)
PWS-1715	0.59"(15.0)	0.66"(16.7)	0.91"(23.0)	0.20"(5.0)	0.19"(4.8)	0.079"(2.4)

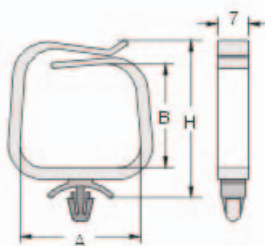
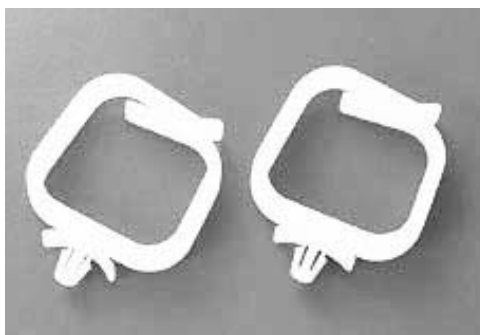

PWS-2824

Wire Saddles

- Material: UL approved Nylon 66, 94V-2
- Color: Natural

ITEM NUMBER	H inches(mm)	A inches(mm)	B inches(mm)	Hole inches(mm)	Thickness inches(mm)
PWS-2824	1.39"(35.3)	1.09"(27.6)	0.94"(24.0)	0.19"(4.8)	0.079"(2.4)

PUSH-IN MOUNT CABLE CLIPS WIRE SADDLES, TWIST CLIPS

F14

Push-in Wire Saddles



Wire Saddle Clips

- Material: UL approved Nylon 66, 94V-2
- Color: Natural

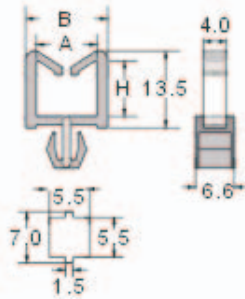

KWS-1110

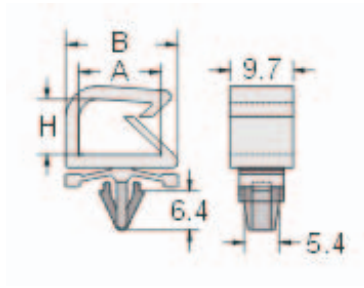

KWS-1308

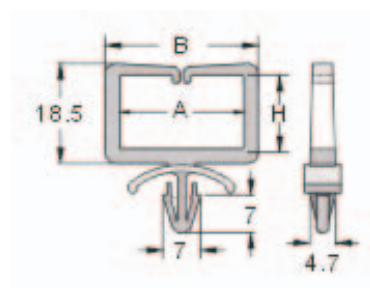

KWS-2314

ITEM NUMBER	H inches(mm)	A inches(mm)	B inches(mm)	Hole inches(mm)	Thickness inches(mm)
KWS-1110	0.38"(9.8)	0.43"(10.9)	0.57"(14.4)	As Figure	0.09"(2.2)
KWS-1308	0.33"(8.5)	0.50"(12.7)	0.68"(17.2)	0.23"(5.8)	0.06"(1.6)
KWS-2314	0.54"(13.6)	0.90"(22.9)	1.11"(28.3)	0.19"(4.8)	0.13"(3.4)

Twist Clips

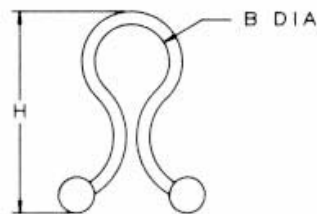

ITEM NUMBER	B	OVERALL HEIGHT (H)
TC125N	.11 / .14	0.715"
TC250N	.20 / .27	0.875"
TC0375N	.30 / .40	1.080"
TC0500N	.40 / .50	1.200"
TC0600N	.55 / .65	1.260"
TC0750N	.70 / .80	1.550"
TC0950N	.90 / 1.00	1.870"
TC1125N	1.20 / 1.30	2.170"
TC1375N	1.45 / 1.55	2.670"
TC1500N	1.55 / 1.65	2.930"
TC1750N	1.90 / 2.00	3.460"

Twist Clips

A fast, economical way to securely position and hold wire, cable or tubing. A single twist of the finger locks the bundle together. Another twist will open the lock to add or remove wire to the bundle.

Made of Nylon 6/6 (UL 94V2).

RUBBER GROMMETS

Rubber Grommets - Open or Closed Style

F15

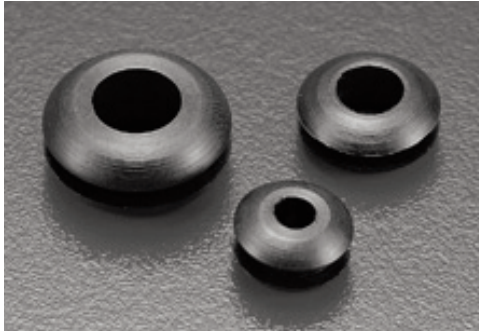

Rubber Grommets

Ideal for electrical insulation and mechanical damping.

Made of rubber.

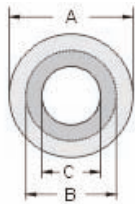

GM, GMQ Type

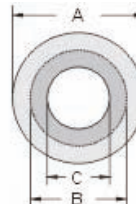

GMC, GMCQ Type

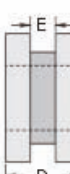
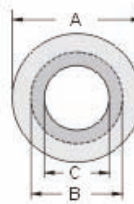

GM-1108, GMQ-1108

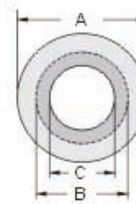

GMC-1108, GMCQ-1108

Wire Saddle

OPEN	CLOSED	A inches(mm)	B inches(mm)	C inches(mm)	D inches(mm)	E inches(mm)
GM-0603	GMC-0603	0.33"(8.5)	0.24"(6)	0.12"(3)	0.19"(4.7)	0.07"(1.7)
GM-0705	GMC-0705	0.40"(10.2)	0.28"(7.2)	0.19"(5)	0.17"(4.4)	0.07"(1.7)
GM-1006	GMC-1006	0.52"(13.3)	0.39"(10)	0.25"(6.4)	0.25"(6.3)	0.07"(1.7)
GM-1108S	GMC-1108S	0.61"(15.5)	0.43"(10.9)	0.31"(7.8)	0.31"(7.8)	0.09"(2.3)
GM-1108	GMC-1108	0.61"(15.5)	0.43"(11)	0.31"(7.8)	0.35"(9)	0.12"(3)
GM-1410	GMC-1410	0.77"(19.5)	0.55"(13.9)	0.41"(10.5)	0.25"(6.4)	0.13"(3.4)
GM-2015	GMC-2015	0.93"(23.7)	0.79"(20.1)	0.61"(15.5)	0.24"(6.1)	0.07"(1.7)
GM-2518	GMC-2518	1.18"(29.9)	0.99"(25.1)	0.74"(18.9)	0.28"(7.2)	0.06"(1.5)
GM-3225	GMC-3225	1.50"(38.1)	1.25"(31.7)	0.98"(25)	0.31"(7.8)	0.06"(1.5)
GMQ-0603	GMCQ-0603	0.33"(8.5)	0.24"(6)	0.12"(3)	0.19"(4.7)	0.07"(1.7)
GMQ-0705	GMCQ-0705	0.40"(10.2)	0.28"(7.2)	0.20"(5)	0.17"(4.4)	0.07"(1.7)
GMQ-1006	GMCQ-1006	0.52"(13.3)	0.39"(10)	0.25"(6.4)	0.25"(6.3)	0.07"(1.7)
GMQ-1108S	GMCQ-1108S	0.61"(15.5)	0.43"(10.9)	0.31"(7.8)	0.31"(7.8)	0.09"(2.3)
GMQ-1108	GMCQ-1108	0.61"(15.5)	0.43"(11)	0.31"(7.8)	0.35"(9)	0.12"(3)
GMQ-1410	GMCQ-1410	0.77"(19.5)	0.55"(13.9)	0.41"(10.5)	0.25"(6.4)	0.13"(3.4)
GMQ-2015	GMCQ-2015	0.93"(23.7)	0.79"(20.1)	0.61"(15.5)	0.24"(6.1)	0.07"(1.7)
GMQ-2518	GMCQ-2518	1.18"(29.9)	0.99"(25.1)	0.74"(18.9)	0.28"(7.2)	0.06"(1.5)
GMQ-3225	GMCQ-3225	1.50"(38.1)	1.25"(31.7)	0.98"(25)	0.31"(7.8)	0.06"(1.5)